

**MODEL CD-7250 COMPACT  
DISC AUTOMATIC CHANGER  
EXTERIOR SHEET # 1 (420-5044)  
FAXBACK DOC # 10827**

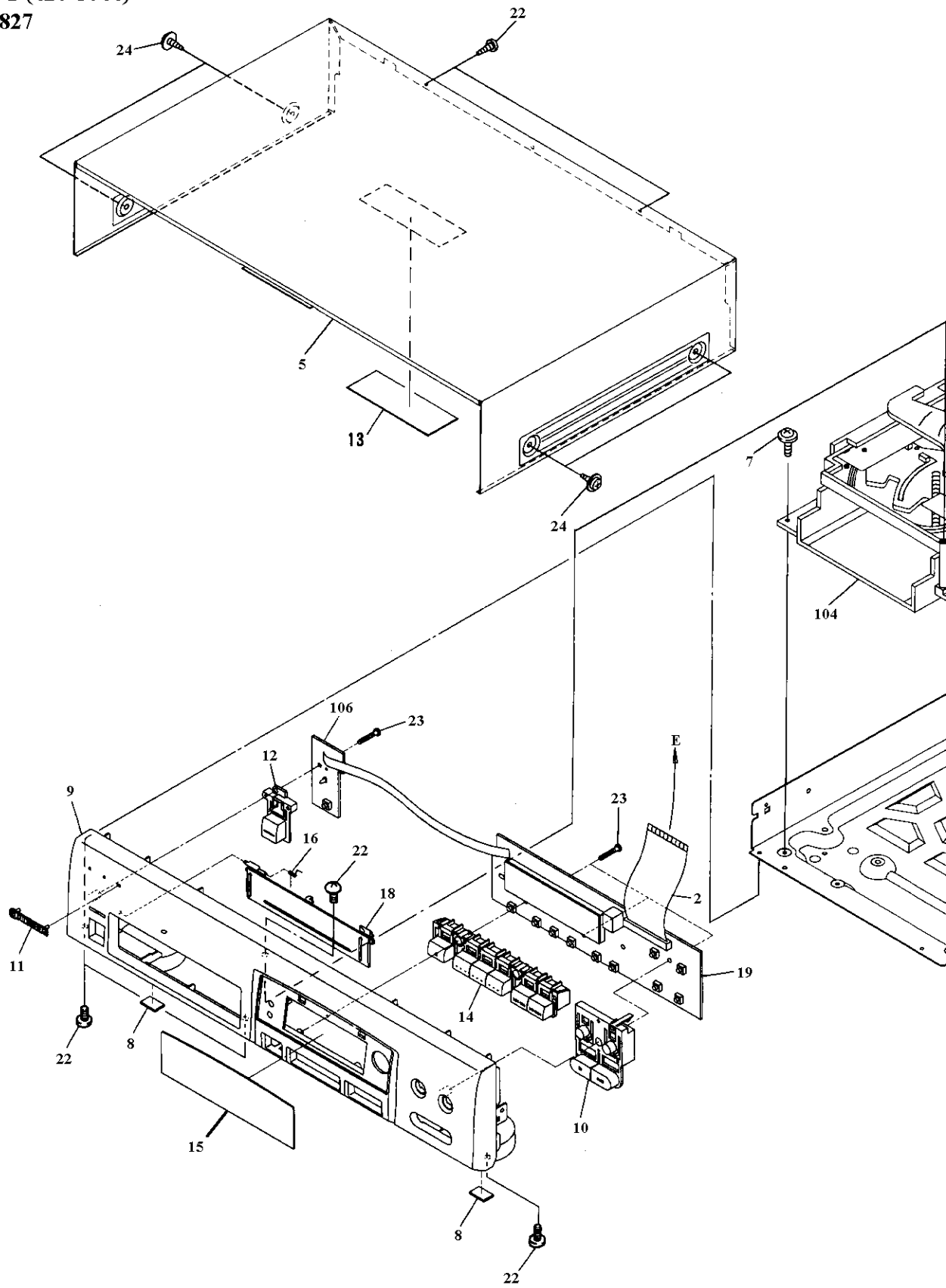

**MODEL CD-7250 COMPACT  
DISC AUTOMATIC CHANGER  
EXTERIOR SHEET # 2 (420-5044)  
FAXBACK DOC # 10827**

